

## CHEVROFLEX ULTRA™ INSTALLATION INSTRUCTIONS



Ensure that personnel carrying out this conversion have the relevant qualifications/certificates. Ensure that all relevant personnel read the points listed within this leaflet and that a copy is given to staff involved with the installation and maintenance of this product. Glasdon recommends that a full Health and Safety analysis is carried out prior to installation.

### KIT CONTENTS

- ① - UPPER CLIPS  
 - M8 Countersunk Screws  
 - 5mm Allen Key

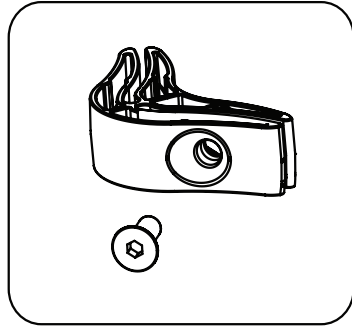

- ② - IMPACTAFLEX™ UPRIGHTS

- ③ - REAR SOCKET COVERS  
 - Screw Covers  
 - M10 Screws  
 - M10 Washers  
 - 6mm Allen Key

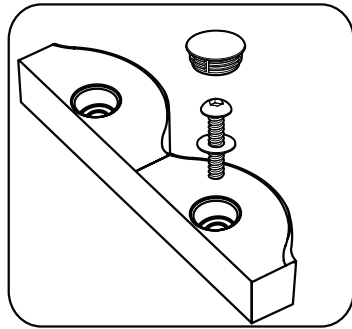

- ④ - STEEL SOCKETS  
 - M8 x 20 Screws  
 - M8 Washers  
 - M8 Nyloc Nuts

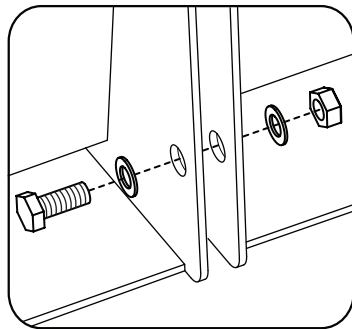

[Quantities will vary depending on model purchased]

### EQUIPMENT REQUIRED

- Spade or Jack Hammer if required
- Spirit Level
- Rubber Hammer
- Appropriate Lubricant or Grease for screw threads
- Concrete Mix (we suggest using a quick setting concrete i.e. QC10 for all installations)
- Safety Equipment (hard hat, mask, goggles, reflective clothing, etc)
- Hand Drill with 5mm and 6mm drill bits (optional)

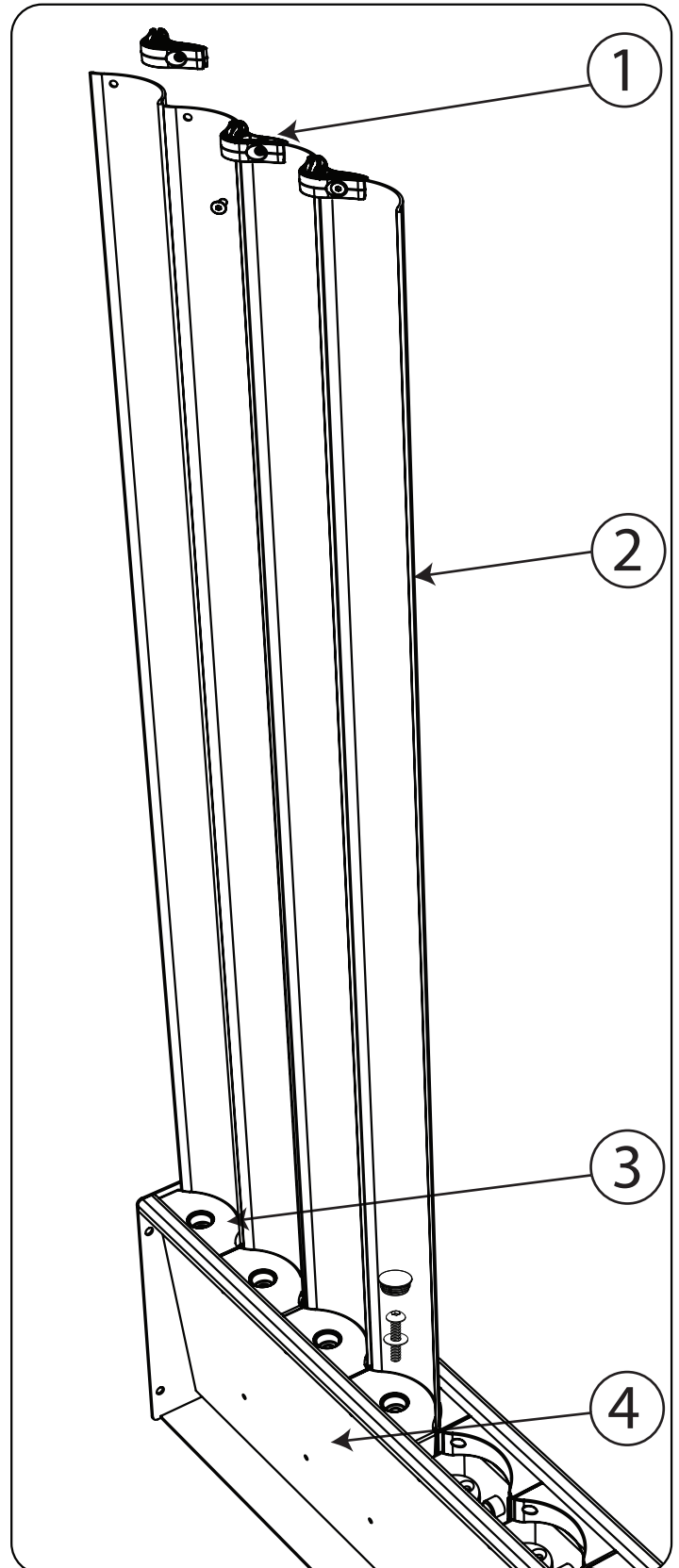

Please note that diagrams are not to scale

## ESTABLISHING THE CONFIGURATION OF THE SOCKETS

### Chevroflex Ultra **with** High Visibility Surround

The type and quantities of sockets will vary dependant on the model purchased.

See diagrams to the right to see the order the sockets must be attached together.

*Example: for 400mm Right Hand Bend with 3 Chevrons the order of sockets is 5-4-5.*

For larger units the middle socket is duplicated.

*Example: 400mm Right Hand Bend with 4 Chevrons the order would be 5-4-4-5.*

### 400MM CHEVROFLEX WITH HIGH VISIBILITY SURROUND

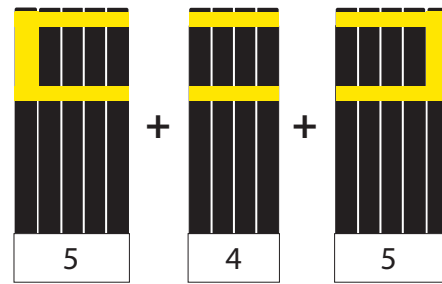

### 600MM CHEVROFLEX WITH HIGH VISIBILITY SURROUND

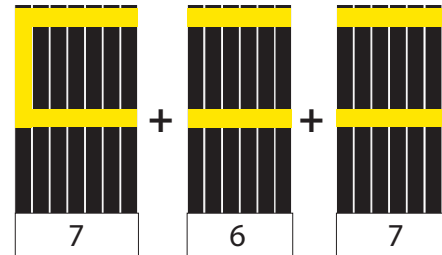

### 800MM CHEVROFLEX WITH HIGH VISIBILITY SURROUND

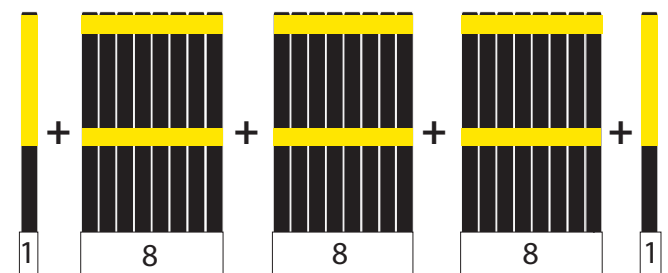

### Chevroflex Ultra **without** High Visibility Surround

The sockets are all the same size and are therefore attached in any order.

## ATTACHING THE SOCKETS TOGETHER

When the order of the sockets has been established the sockets must be fixed together prior to installation.

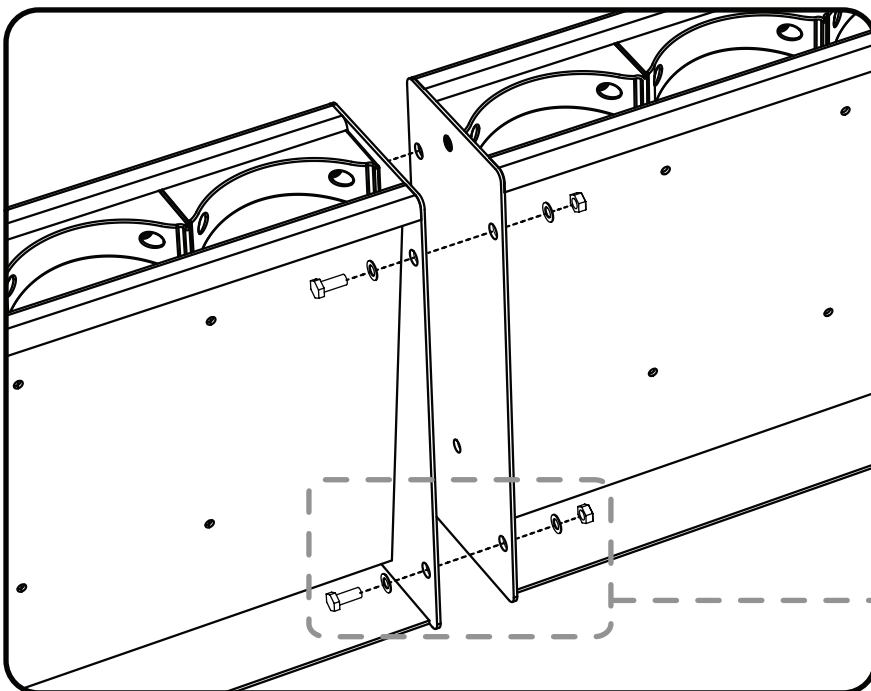

Using the M8 x 20 screws, M8 washers and M8 nyloc nuts provided attach the sockets together as shown. Each socket is attached in four places with each fixing required a screw, two washers and a nut.

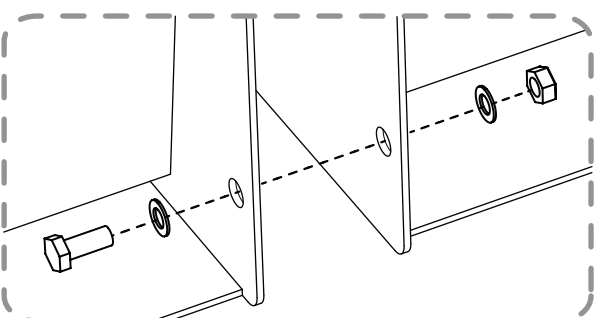

## SOCKET INSTALLATION

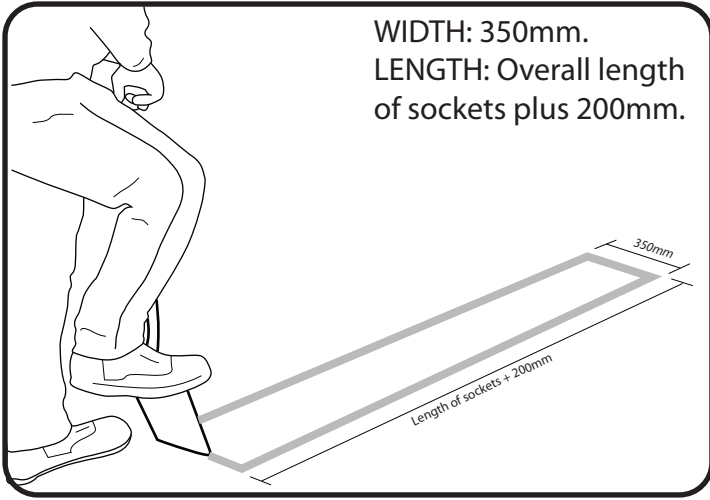

WIDTH: 350mm.  
LENGTH: Overall length  
of sockets plus 200mm.

Measure the size of the hole to be excavated. Check for buried services then dig the hole to a depth of 450mm. Line the hole with 50mm of gravel for drainage and ensure base of hole is flat.

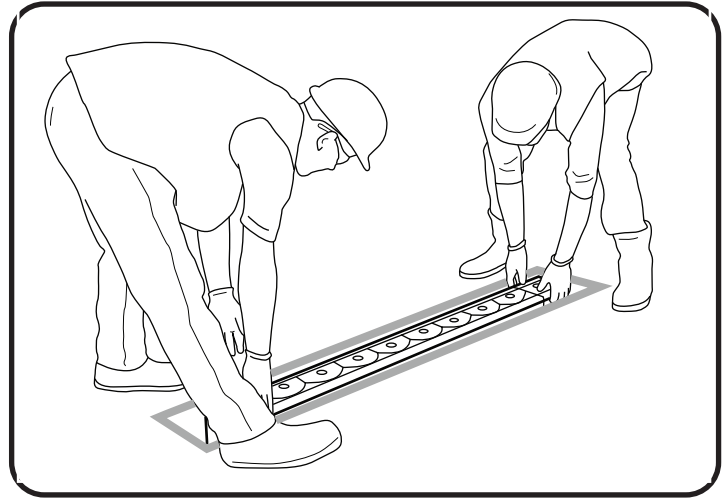

Position the socket into the hole.

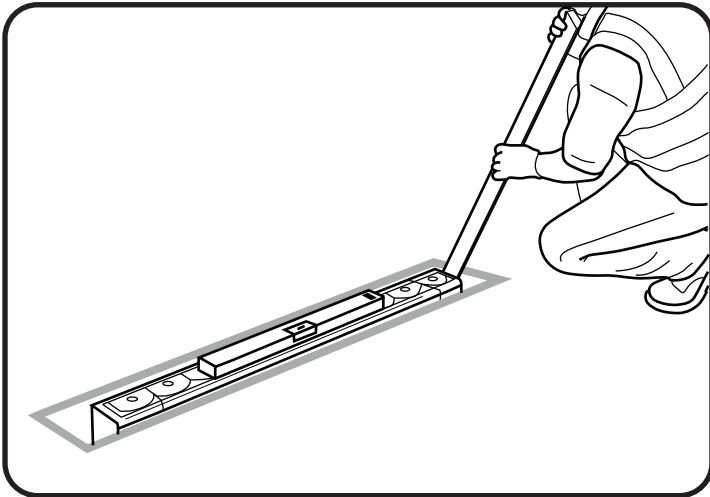

Ensure socket is level, add/remove gravel as required.

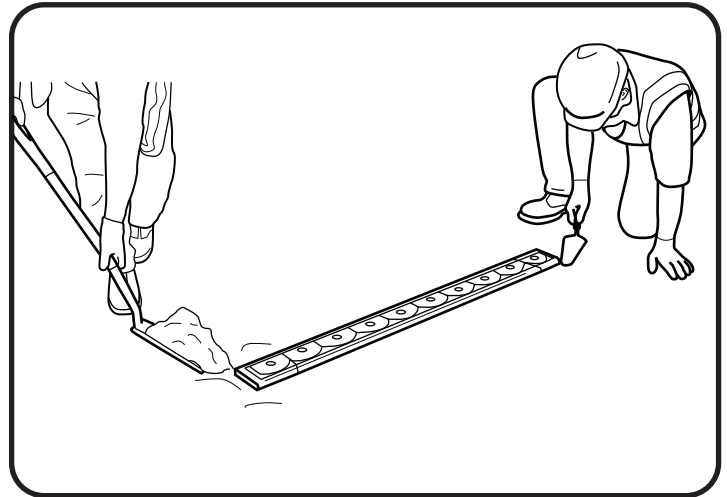

Using a quick setting concrete fill around the socket and smooth for a neat finish. Again, ensure socket is level. Clean any debris from the top of the socket.

## UPRIGHT INSTALLATION

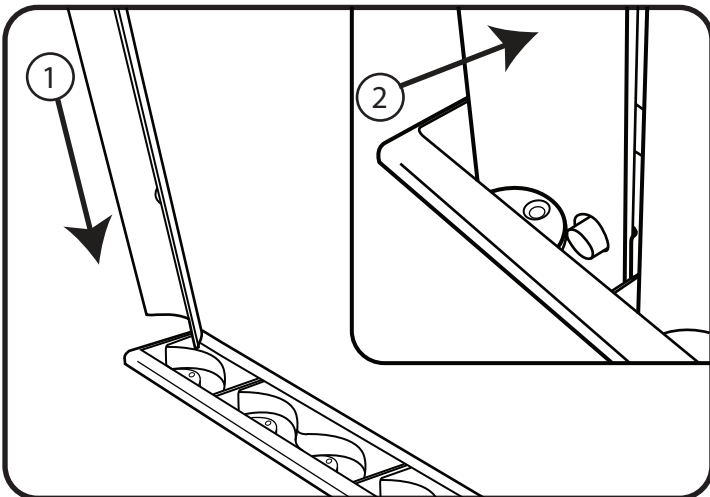

Lay out all the uprights on the ground in order then begin inserting the upright into the sockets at a slight angle and push forward to locate hole in upright onto the pin in socket.

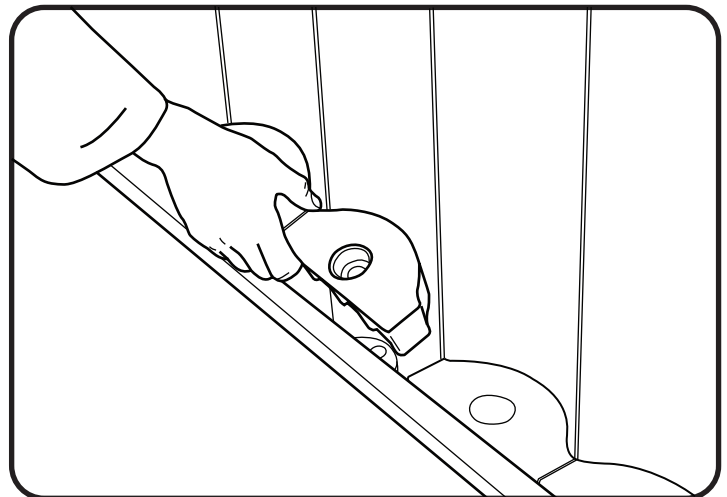

Insert socket covers by hand and use a rubber hammer to secure into place.

## UPRIGHT INSTALLATION (Continued)

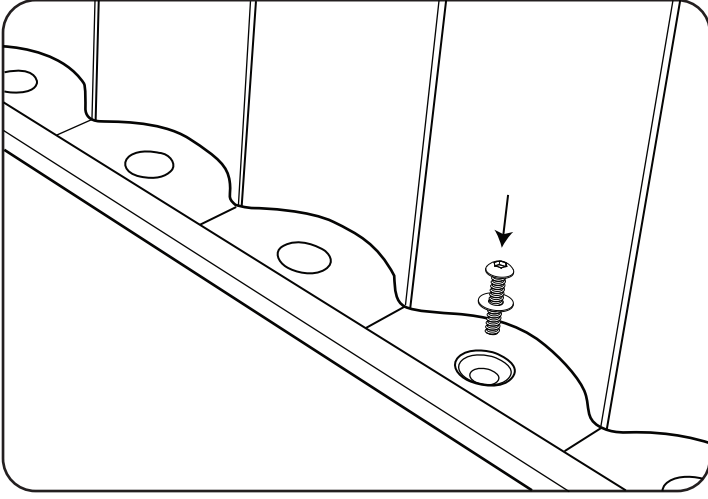

Fix the socket covers to the socket using the M10 screws and washers provided. Tighten using the 6mm allen key provided or use a hand drill if available.

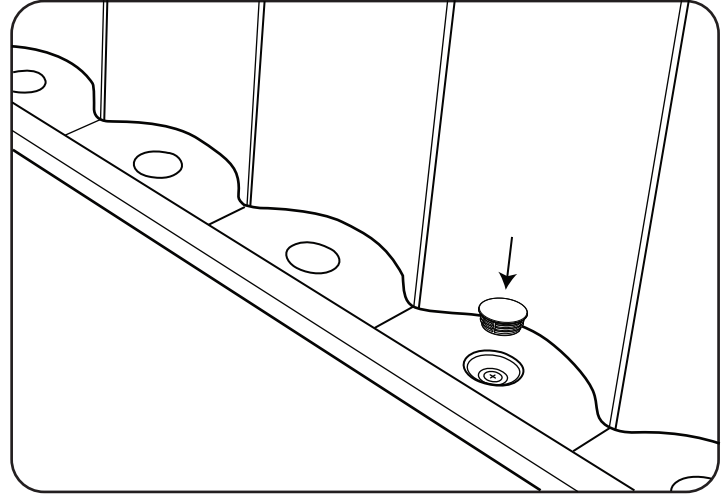

Position the screw covers over the tightened screws and secure into place using a rubber hammer.

## UPPER CLIP INSTALLATION

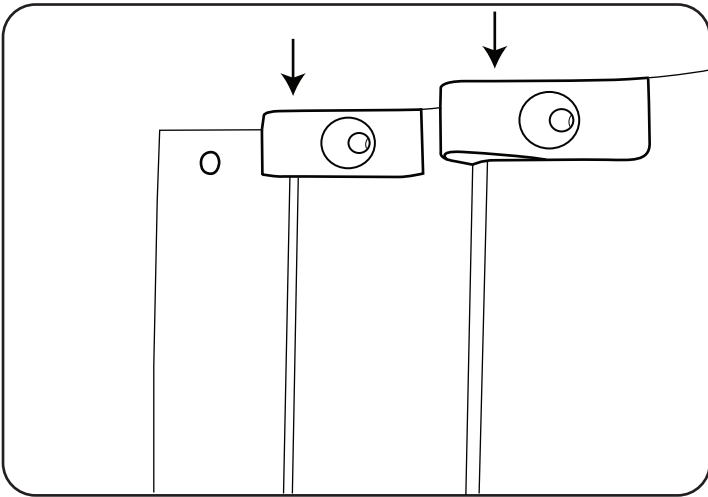

Each Upper Clip is located between two Uprights. To attach slide the Clip down onto the Uprights.

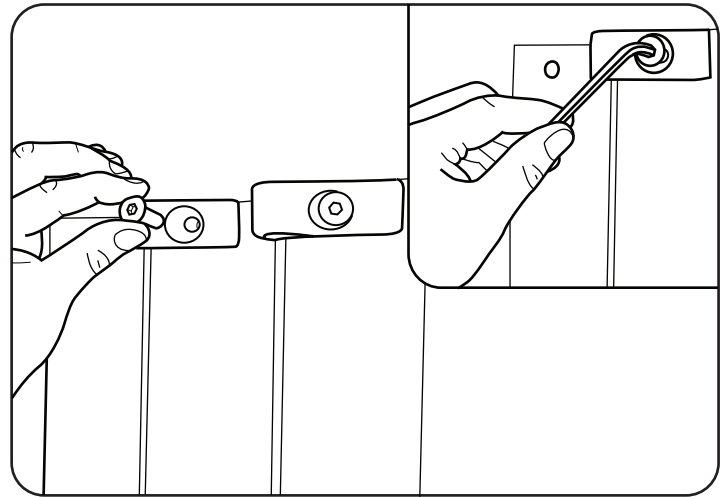

Secure clips using the M8 countersunk screws and tighten using the 5mm allen key provided. For speed use a hand drill if available.

## ATTACHING A SIGN

### KIT CONTENTS

- Stainless Steel Socket Button Screws (M6 x 20mm)
- Rubber Washers (5mm ID x 20mm x 2mm)
- Stainless Steel Washers (M6 x 18mm x 1.5mm)
- 4mm Allen Key
- Sign

*\*Quantities variable dependant on the size of sign (one of each of the above per fixing point).*

Minimum of two people required (three for larger signs).

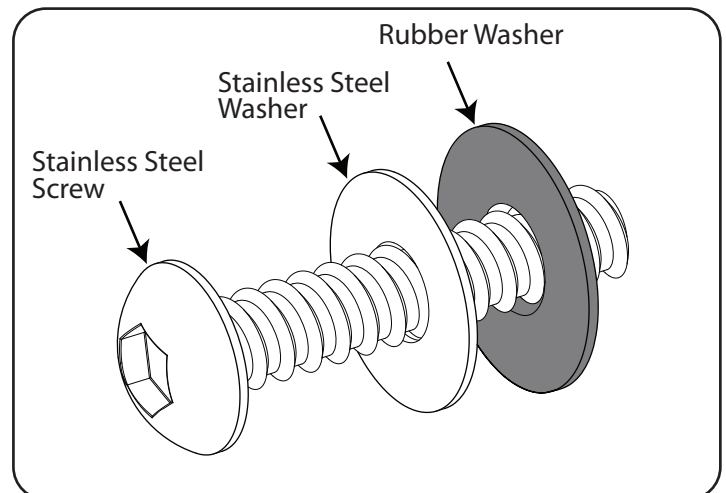

Assemble the fixings as shown above. Have one person hold the sign in position and align the fixing points. Insert the screw and washers and tighten well using the allen key provided.

# REPLACING DAMAGED UPRIGHTS

## REMOVING THE DAMAGED UPRIGHTS

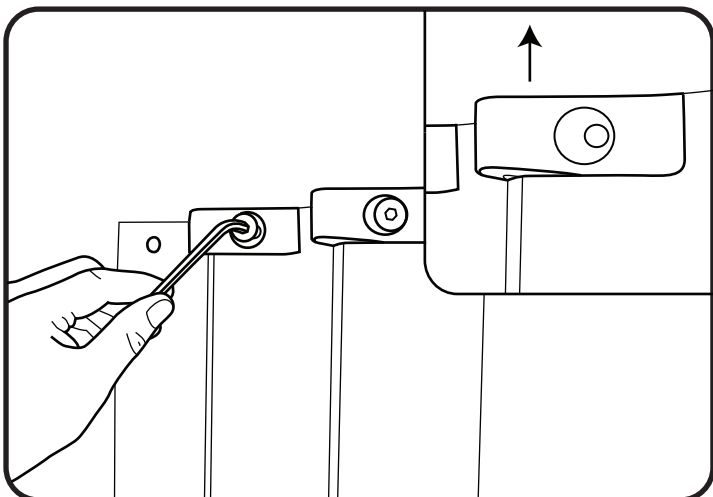

Remove the screws from the Upper Clips on the damaged Uprights using a 5mm allen key. Remove these Upper Clips by sliding upwards.

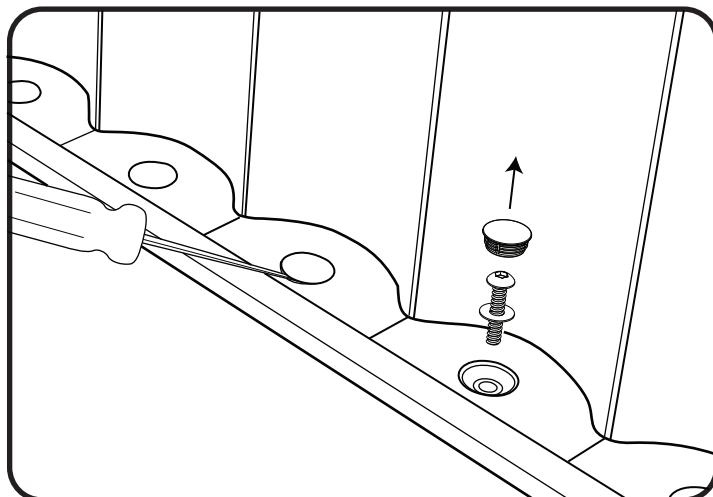

Remove the Screw Covers from behind the damaged uprights. To do this use a flat head screw driver or similar to prise the covers off. Remove the screws from beneath using a 6mm allen key.

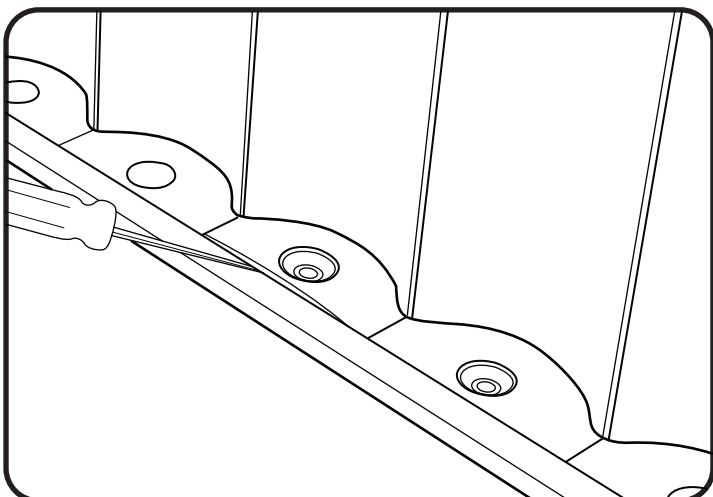

Remove the socket covers in a similar way to the removal of the screw covers.

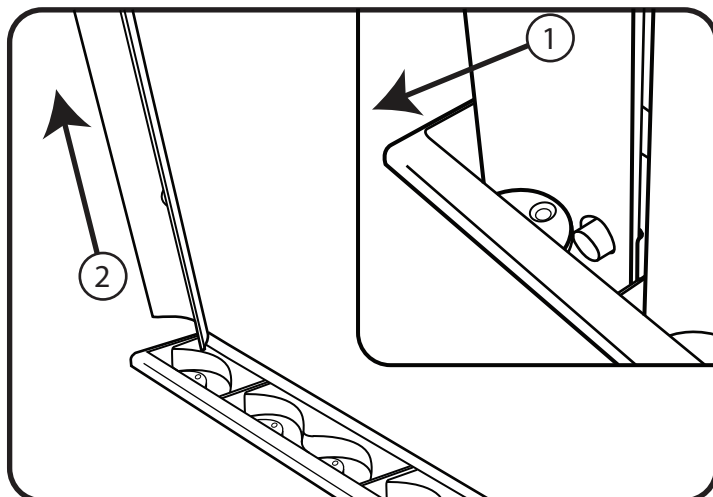

Tilt back Upright and lift out of socket.

## INSTALLING REPLACEMENT UPRIGHTS

Refer to pages 3 and 4 for 'Upright Installation' and 'Upper Clip Installation'.

**IMPORTANT NOTE:** PLEASE ENSURE THAT ALL RELEVANT PERSONNEL READ THE POINTS LISTED WITHIN THIS LEAFLET AND THAT A COPY IS GIVEN TO STAFF INVOLVED WITH THE INSTALLATION AND MAINTENANCE OF THIS PRODUCT.

**SAFETY NOTE:** PLEASE REFER TO 'THE MANUAL HANDLING OPERATIONS REGULATIONS 1992' DURING HANDLING.

 **Glasdon** AND CHEVROFLEX ULTRA ARE TRADEMARKS OR REGISTERED TRADEMARKS OF GLASDON GROUP OR ITS SUBSIDIARIES IN THE U.K AND OTHER COUNTRIES

• A planned maintenance schedule or regular inspection is recommended, replacing components as necessary.

• Replacement components are available direct from GLASDON.

• GLASDON cannot be held responsible for claims arising from incorrect installation, unauthorised modifications or misuse of the product.

Stock No. C000/0379 - DWG No. 02B-069-58 Issue 2 - November 2017

© Copyright Nov 2017

Glasdon UK Ltd reserve the right to alter specifications without prior notice.



Glasdon U.K Limited

Preston New Road

BLACKPOOL

Lancashire FY4 4UL

Tel: 01253 600410

Fax: 01253 792558

email: sales@glasdon-uk.co.uk

web: www.glasdon.com